

# ALUMINUM DRIVE RIVETS

## Ø 3.2 (.125)

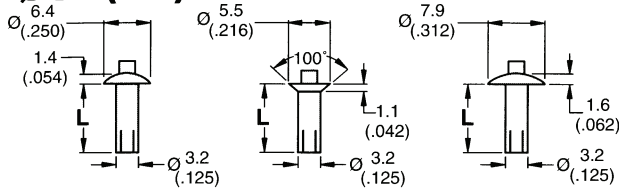

## Ø 4 (.156)

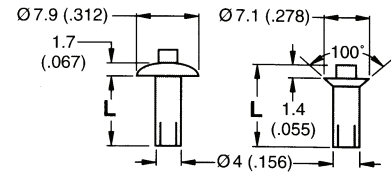

PART NUMBERS			L	GRIP			L	PART NUMBERS	
Universal Head	100° CSK Head	Full Brazier Head		MIN.	NOM.	MAX.		Universal Head	100° CSK Head
38-104-01-13			4 (.156)	0.4 (.016)	0.8 (.031)	1.2 (.047)	4.8 (.188)	38-105-01-13	
38-104-02-13			4 (.156)	1.2 (.047)	1.6 (.063)	2 (.078)	4.8 (.188)	38-105-02-13	
38-104-03-13	38-504-03-13	38-204-03-13	4.8 (.188)	2 (.078)	2.4 (.094)	2.8 (.109)	5.6 (.219)	38-105-03-13	
38-104-04-13	38-504-04-13	38-204-04-13	5.6 (.219)	2.8 (.109)	3.2 (.125)	3.6 (.141)	6.4 (.250)	38-105-04-13	38-505-04-13
38-104-05-13	38-504-05-13	38-204-05-13	6.4 (.250)	3.6 (.141)	4 (.156)	4.4 (.172)	7.1 (.281)	38-105-05-13	38-505-05-13
38-104-06-13	38-504-06-13	38-204-06-13	7.1 (.281)	4.4 (.172)	4.8 (.188)	5.2 (.203)	7.9 (.313)	38-105-06-13	38-505-06-13
38-104-07-13	38-504-07-13	38-204-07-13	7.9 (.313)	5.2 (.203)	5.6 (.219)	6 (.234)	8.7 (.344)	38-105-07-13	38-505-07-13
38-104-08-13	38-504-08-13	38-204-08-13	8.7 (.344)	6 (.234)	6.4 (.250)	6.8 (.266)	9.5 (.375)	38-105-08-13	38-505-08-13
38-104-09-13	38-504-09-13	38-104-09-13	9.5 (.375)	6.8 (.266)	7.1 (.281)	7.5 (.297)	10.3 (.406)	38-105-09-13	38-505-09-13
38-104-10-13	38-504-10-13		10.3 (.406)	7.5 (.297)	7.9 (.313)	8.3 (.328)	11.1 (.438)	38-105-10-13	38-505-10-13
38-104-11-13	38-504-11-13		11.1 (.438)	8.3 (.328)	8.7 (.344)	9.1 (.359)	11.9 (.469)	38-105-11-13	38-505-11-13
38-104-12-13	38-504-12-13	38-204-12-13	11.9 (.469)	9.1 (.359)	9.5 (.375)	9.9 (.391)	12.7 (.500)	38-105-12-13	38-505-12-13
38-104-13-13	38-504-13-13		12.7 (.500)	9.9 (.391)	10.3 (.406)	10.7 (.422)	13.5 (.531)	38-105-13-13	38-505-13-13
38-104-14-13			13.5 (.531)	10.7 (.422)	11.1 (.438)	11.5 (.453)	14.3 (.563)	38-105-14-13	38-505-14-13
				11.5 (.453)	11.9 (.469)	12.3 (.484)	15.1 (.594)	38-105-15-13	38-505-15-13
				12.3 (.484)	12.7 (.500)	13.1 (.516)	15.9 (.625)	38-105-16-13	38-505-16-13
				13.1 (.516)	13.5 (.531)	13.9 (.547)	16.7 (.656)	38-105-17-13	38-505-17-13
				13.9 (.547)	14.3 (.563)	14.7 (.578)	17.5 (.688)	38-105-18-13	38-505-18-13
				14.7 (.578)	15.1 (.594)	15.5 (.609)	18.3 (.719)	38-105-19-13	38-505-19-13
				15.5 (.609)	15.9 (.625)	16.3 (.641)	19.1 (.750)	38-105-20-13	38-505-20-13

## Ø 4.8 (.188)

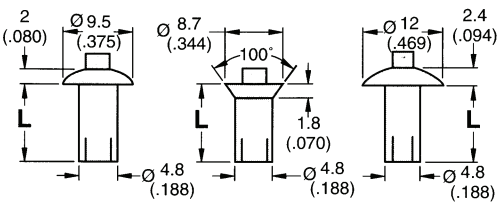

## Ø 6.4 (.250)

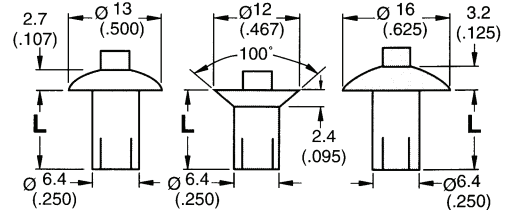

PART NUMBERS			L	GRIP			L	PART NUMBERS		
Universal Head	100° CSK Head	Full Brazier Head		MIN.	NOM.	MAX.		Universal Head	100° CSK Head	Full Brazier Head
38-106-02-16		38-206-02-16	6.4 (.250)	1.2 (.047)	2.4 (.094)	3.6 (.141)	6.4 (.250)	38-108-02-16		38-208-02-16
38-106-04-16		38-206-04-16	7.1 (.281)	2 (.078)	3.2 (.125)	4.4 (.172)	7.1 (.281)	38-108-04-16		38-208-04-16
38-106-06-16	38-506-06-16	38-206-06-16	8.7 (.344)	3.6 (.141)	4.8 (.188)	6 (.234)	8.7 (.344)	38-108-06-16	38-508-06-16	38-208-06-16
38-106-08-16	38-506-08-16	38-206-08-16	10.3 (.406)	5.2 (.203)	6.4 (.250)	7.5 (.297)	10.3 (.406)	38-108-08-16	38-508-08-16	38-208-08-16
38-106-10-16	38-506-10-16	38-206-10-16	11.9 (.469)	6.8 (.266)	7.9 (.313)	9.1 (.359)	11.9 (.469)	38-108-10-16	38-508-10-16	38-208-10-16
38-106-12-16	38-506-12-16	38-206-12-16	13.5 (.531)	8.3 (.328)	9.5 (.375)	10.7 (.422)	13.5 (.531)	38-108-12-16	38-508-12-16	38-208-12-16
38-106-14-16	38-506-14-16	38-206-14-16	15.1 (.594)	9.9 (.391)	11.1 (.438)	12.3 (.484)	15.1 (.594)	38-108-14-16	38-508-14-16	38-208-14-16
38-106-16-16	38-506-16-16	38-206-16-16	16.7 (.656)	11.5 (.453)	12.7 (.500)	13.9 (.547)	16.7 (.656)	38-108-16-16	38-508-16-16	38-208-16-16
38-106-18-16	38-506-18-16	38-206-18-16	18.3 (.719)	13.1 (.516)	14.3 (.563)	15.5 (.609)	18.3 (.719)	38-108-18-16	38-508-18-16	38-208-18-16
38-106-20-16	38-506-20-16	38-206-20-16	19.8 (.781)	14.7 (.578)	15.9 (.625)	17.1 (.672)	19.8 (.781)	38-108-20-16	38-508-20-16	38-208-20-16
38-106-22-16	38-506-22-16	38-206-22-16	21.4 (.844)	16.3 (.641)	17.5 (.688)	18.7 (.734)	21.4 (.844)	38-108-22-16	38-508-22-16	38-208-22-16
38-106-24-16	38-506-24-16	38-206-24-16	23 (.906)	17.9 (.703)	19.1 (.750)	20.3 (.797)	23 (.906)	38-108-24-16	38-508-24-16	38-208-24-16
38-106-26-16	38-506-26-16	38-206-26-16	24.6 (.969)	19.4 (.766)	20.6 (.813)	21.8 (.859)	24.6 (.969)	38-108-26-16	38-508-26-16	38-208-26-16
38-106-28-16	38-506-28-16	38-206-28-16	26.2 (1.031)	21 (.828)	22.2 (.875)	23.4 (.922)	26.2 (1.031)	38-108-28-16	38-508-28-16	38-208-28-16
38-106-30-16	38-506-30-16	38-206-30-16	27.8 (1.094)	22.6 (.891)	23.8 (.938)	25 (.984)	27.8 (1.094)	38-108-30-16	38-508-30-16	38-208-30-16
38-106-32-16	38-506-32-16	38-206-32-16	29.4 (1.156)	24.2 (.953)	25.4 (1.000)	26.6 (1.047)	29.4 (1.156)	38-108-32-16	38-508-32-16	38-208-32-16



# LARGE DIAMETER ALUMINUM DRIVE RIVETS

## Ø 7.9 (.313)

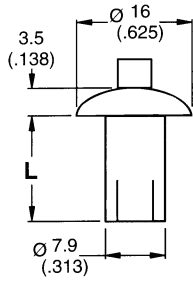

GRIP			L	PART NUMBERS
MIN.	NOM.	MAX.		Universal Head
3.4 (.132)	4.8 (.188)	6.2 (.242)	11.1 (.438)	38-110-06-16
5.7 (.226)	7.1 (.281)	8.5 (.336)	13.5 (.531)	38-110-09-16
8.1 (.320)	9.5 (.375)	10.9 (.430)	15.9 (.625)	38-110-12-16
10.5 (.414)	11.9 (.469)	13.3 (.523)	18.3 (.719)	38-110-15-16
12.9 (.508)	14.3 (.563)	15.7 (.617)	20.6 (.813)	38-110-18-16
15.3 (.601)	16.7 (.656)	18.1 (.711)	23 (.906)	38-110-21-16
17.7 (.695)	19.1 (.750)	20.5 (.804)	25.4 (1.000)	38-110-24-16
20 (.789)	21.4 (.844)	22.8 (.898)	27.8 (1.094)	38-110-27-16
22.4 (.882)	23.8 (.938)	25.2 (.992)	30.2 (1.188)	38-110-30-16
24.8 (.976)	26.2 (1.031)	27.6 (1.086)	32.5 (1.281)	38-110-33-16

## Ø 9.5 (.375)

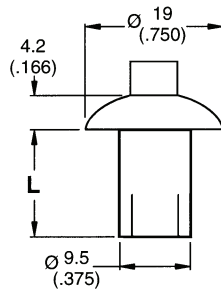

GRIP			L	PART NUMBERS
MIN.	NOM.	MAX.		Universal Head
3.2 (.125)	4.8 (.188)	6.4 (.250)	12.7 (.500)	38-112-06-16
5.5 (.219)	7.1 (.281)	8.7 (.344)	15.1 (.594)	38-112-09-16
7.9 (.313)	9.5 (.375)	11.1 (.438)	17.5 (.688)	38-112-12-16
10.3 (.406)	11.9 (.469)	13.5 (.531)	19.8 (.781)	38-112-15-16
12.7 (.500)	14.3 (.563)	15.9 (.625)	22.2 (.875)	38-112-18-16
15.1 (.594)	16.7 (.656)	18.3 (.719)	24.6 (.969)	38-112-21-16
17.5 (.688)	19.1 (.750)	20.7 (.813)	27 (1.063)	38-112-24-16
19.8 (.781)	21.4 (.844)	23 (.906)	29.4 (1.156)	38-112-27-16
22.2 (.875)	23.8 (.938)	25.4 (1.000)	31.8 (1.250)	38-112-30-16
24.6 (.969)	26.2 (1.031)	27.8 (1.094)	34.1 (1.344)	38-112-33-16



# STEEL DRIVE RIVETS

## Ø 3.2 (.125)

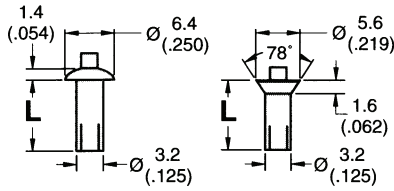

## Ø 4.8 (.188)

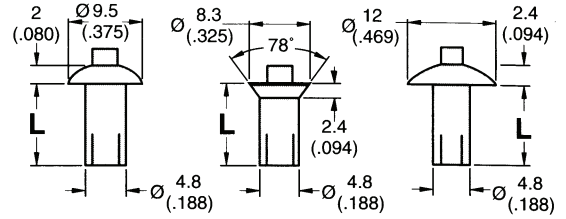

PART NUMBERS		L	GRIP			L	PART NUMBERS		
Universal Head	100° CSK Head		MIN.	NOM.	MAX.		Universal Head	100° CSK Head	Full Brazier Head
38-104-01-93		4 (.156)	0.4 (.016)	0.8 (.031)	1.2 (.047)				
38-104-02-93		4 (.156)	1.2 (.047)	1.6 (.063)	2 (.078)	5.6 (.219)		38-206-02-91	
38-104-03-93	38-604-03-93	4.8 (.188)	2 (.078)	2.4 (.094)	2.8 (.109)	5.6 (.219)	38-106-03-91	38-206-03-91	
38-104-04-93	38-604-04-93	5.6 (.219)	2.8 (.109)	3.2 (.125)	3.6 (.141)	6.4 (.250)	38-106-04-91	38-206-04-91	
38-104-05-93	38-604-05-93	6.4 (.250)	3.6 (.141)	4 (.156)	4.4 (.172)	7.1 (.281)	38-106-05-91	38-206-05-91	
38-104-06-93	38-604-06-93	7.1 (.281)	4.4 (.172)	4.8 (.188)	5.2 (.203)	7.9 (.313)	38-106-06-91	38-606-06-91 38-206-06-91	
38-104-07-93	38-604-07-93	7.9 (.313)	5.2 (.203)	5.6 (.219)	6 (.234)	8.7 (.344)	38-106-07-91	38-606-07-91 38-206-07-91	
38-104-08-93	38-604-08-93	8.7 (.344)	6 (.234)	6.4 (.250)	6.8 (.266)	9.5 (.375)	38-106-08-91	38-606-08-91 38-206-08-91	
38-104-09-93	38-604-09-93	9.5 (.375)	6.8 (.266)	7.1 (.281)	7.5 (.297)	10.3 (.406)	38-106-09-91	38-606-09-91 38-206-09-91	
38-104-10-93	38-604-10-93	10.3 (.406)	7.5 (.297)	7.9 (.313)	8.3 (.328)	11.1 (.438)	38-106-10-91	38-606-10-91 38-206-10-91	
38-104-11-93	38-604-11-93	11.1 (.438)	8.3 (.328)	8.7 (.344)	9.1 (.359)	11.9 (.469)	38-106-11-91	38-606-11-91	
38-104-12-93	38-604-12-93	11.9 (.469)	9.1 (.359)	9.5 (.375)	9.9 (.391)	12.7 (.500)	38-106-12-91	38-606-12-91	
38-104-13-93	38-604-13-93	12.7 (.500)	9.9 (.391)	10.3 (.406)	10.7 (.422)	13.5 (.531)	38-106-13-91	38-606-13-91 38-206-13-91	
38-104-14-93		13.5 (.531)	10.7 (.422)	11.1 (.438)	11.5 (.453)	14.3 (.563)	38-106-14-91	38-606-14-91 38-206-14-91	
			11.5 (.453)	11.9 (.469)	12.3 (.484)	15.1 (.594)	38-106-15-91	38-606-15-91	
			12.3 (.484)	12.7 (.500)	13.1 (.516)	15.9 (.625)	38-106-16-91	38-606-16-91 38-206-16-91	
			13.1 (.516)	13.5 (.531)	13.9 (.547)	16.7 (.656)	38-106-17-91	38-606-17-91	
			13.9 (.547)	14.3 (.563)	14.7 (.578)	17.5 (.688)	38-106-18-91	38-606-18-91	
			14.7 (.578)	15.1 (.594)	15.5 (.609)	18.3 (.719)	38-106-19-91	38-606-19-91	
			15.5 (.609)	15.9 (.625)	16.3 (.641)	19.1 (.750)	38-106-20-91	38-606-20-91 38-206-20-91	

## Ø 6.4 (.250)

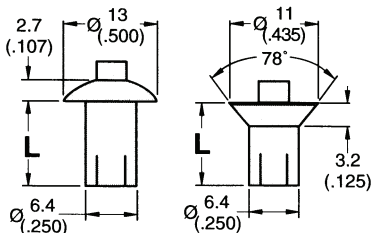

GRIP			L	PART NUMBERS	
MIN.	NOM.	MAX.		Universal Head	78° CSK Head
2 (.078)	2.4 (.094)	2.8 (.109)	5.6 (.219)	38-108-03-91	
2.8 (.109)	3.2 (.125)	3.6 (.141)	6.4 (.250)	38-108-04-91	
3.6 (.141)	4 (.156)	4.4 (.172)	7.1 (.281)	38-108-05-91	
4.4 (.172)	4.8 (.188)	5.2 (.203)	7.9 (.313)	38-108-06-91	38-608-06-91
5.2 (.203)	5.6 (.219)	6 (.234)	8.7 (.344)	38-108-07-91	38-608-07-91
6 (.234)	6.4 (.250)	6.8 (.266)	9.5 (.375)	38-108-08-91	38-608-08-91
6.8 (.266)	7.1 (.281)	7.5 (.297)	10.3 (.406)	38-108-09-91	38-608-09-91
7.5 (.297)	7.9 (.313)	8.3 (.328)	11.1 (.438)	38-108-10-91	38-608-10-91
8.3 (.328)	8.7 (.344)	9.1 (.359)	11.9 (.469)	38-108-11-91	38-608-11-91
9.1 (.359)	9.5 (.375)	9.9 (.391)	12.7 (.500)	38-108-12-91	38-608-12-91
9.9 (.391)	10.3 (.406)	10.7 (.422)	13.5 (.531)	38-108-13-91	38-608-13-91
10.7 (.422)	11.1 (.438)	11.5 (.453)	14.3 (.563)	38-108-14-91	38-608-14-91
11.5 (.453)	11.9 (.469)	12.3 (.484)	15.1 (.594)	38-108-15-91	38-608-15-91
12.3 (.484)	12.7 (.500)	13.1 (.516)	15.9 (.625)	38-108-16-91	38-608-16-91
13.1 (.516)	13.5 (.531)	13.9 (.547)	16.7 (.656)	38-108-17-91	38-608-17-91
13.9 (.547)	14.3 (.563)	14.7 (.578)	17.5 (.688)	38-108-18-91	38-608-18-91
14.7 (.578)	15.1 (.594)	15.5 (.609)	18.3 (.719)	38-108-19-91	38-608-19-91
15.5 (.609)	15.9 (.625)	16.3 (.641)	19.1 (.750)	38-108-20-91	38-608-20-91



# STEEL DRIVE RIVETS

## Ø 7.9 (.313)

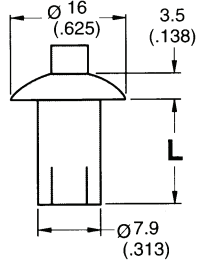

GRIP			L	PART NUMBERS
MIN.	NOM.	MAX.		Universal Head
2.4 (.094)	3.2 (.125)	4 (.156)	7.9 (.313)	38-110-04-91
4 (.156)	4.8 (.188)	5.6 (.219)	9.5 (.375)	38-110-06-91
5.6 (.219)	6.4 (.250)	7.1 (.281)	11.1 (.438)	38-110-08-91
7.1 (.281)	7.9 (.313)	8.7 (.344)	12.7 (.500)	38-110-10-91
8.7 (.344)	9.5 (.375)	10.3 (.406)	14.3 (.563)	38-110-12-91
10.3 (.406)	11.1 (.438)	11.9 (.469)	15.9 (.625)	38-110-14-91
11.9 (.469)	12.7 (.500)	13.5 (.531)	17.5 (.688)	38-110-16-91
13.5 (.531)	14.3 (.563)	15.1 (.594)	19.1 (.750)	38-110-18-91
15.1 (.594)	15.9 (.625)	16.7 (.656)	20.6 (.813)	38-110-20-91
16.7 (.656)	17.5 (.688)	18.3 (.719)	22.2 (.875)	38-110-22-91
18.3 (.719)	19.1 (.750)	19.8 (.781)	23.8 (.938)	38-110-24-91
19.8 (.781)	20.6 (.813)	21.4 (.844)	25.4 (1.000)	38-110-26-91
21.4 (.844)	22.2 (.875)	23 (.906)	27 (1.063)	38-110-28-91
23 (.906)	23.8 (.938)	24.6 (.969)	28.6 (1.125)	38-110-30-91
24.6 (.969)	25.4 (1.000)	26.2 (1.031)	30.2 (1.188)	38-110-32-91

## Ø 9.5 (.375)

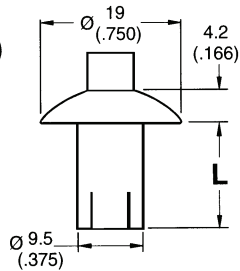

GRIP			L	PART NUMBERS
MIN.	NOM.	MAX.		Universal Head
3.2 (.125)	4.8 (.188)	6.4 (.250)	12.7 (.500)	38-112-06-91
5.6 (.219)	7.1 (.281)	8.7 (.344)	15.1 (.594)	38-112-09-91
7.9 (.313)	9.5 (.375)	11.1 (.438)	17.5 (.688)	38-112-12-91
10.3 (.406)	11.9 (.469)	13.5 (.531)	19.8 (.781)	38-112-15-91
12.7 (.500)	14.3 (.563)	15.9 (.625)	22.2 (.875)	38-112-18-91
15.1 (.594)	16.7 (.656)	18.3 (.719)	24.6 (.969)	38-112-21-91
17.5 (.688)	19.1 (.750)	20.7 (.813)	27 (1.063)	38-112-24-91
19.8 (.781)	21.4 (.844)	23 (.906)	29.4 (1.156)	38-112-27-91
23 (.906)	23.8 (.938)	24.6 (.969)	30.2 (1.188)	38-112-30-91
24.6 (.969)	25.4 (1.000)	26.2 (1.031)	31.8 (1.250)	38-112-32-91